

Timing Points

START: S side of Washington Blvd. and W. Camden St. intersection. Even with the S side of the S most white traffic stripe. 18 ft. S of the overhead light pole.

M 1: 50 ft. N of the N curb of MLK Blvd.

M 2: Approx. 180 ft S of North St. 36 ft. N of the N curb of Gold St.

M 3: 200 ft. W of Brookfield Ave. 250 ft. E of Jones Falls Expressway sign. 46 ft. E of light pole #40.

M 4: Approx. 250 ft W of St. Paul. Even with the center of alley in the middle of the block.

M 5: On the N side of the railroad bridge at Penn Station. 6 ft. S of 1601 doorway.

M 6: Even with the overhead Pleasant St. street sign.

M 7: 60 ft. N of the N curb of Warren Ave.

M 8: Even with the 1407 doorway of Fire Dept. Repair Shop.

M 9: On W end of railroad bridge near Fr. McHenry. 12 ft. E of 3rd storm drain from W end of bridge.

M 10: At the rest rooms next to the parking lot. Even with the concrete sidewalk next to the parking lot.

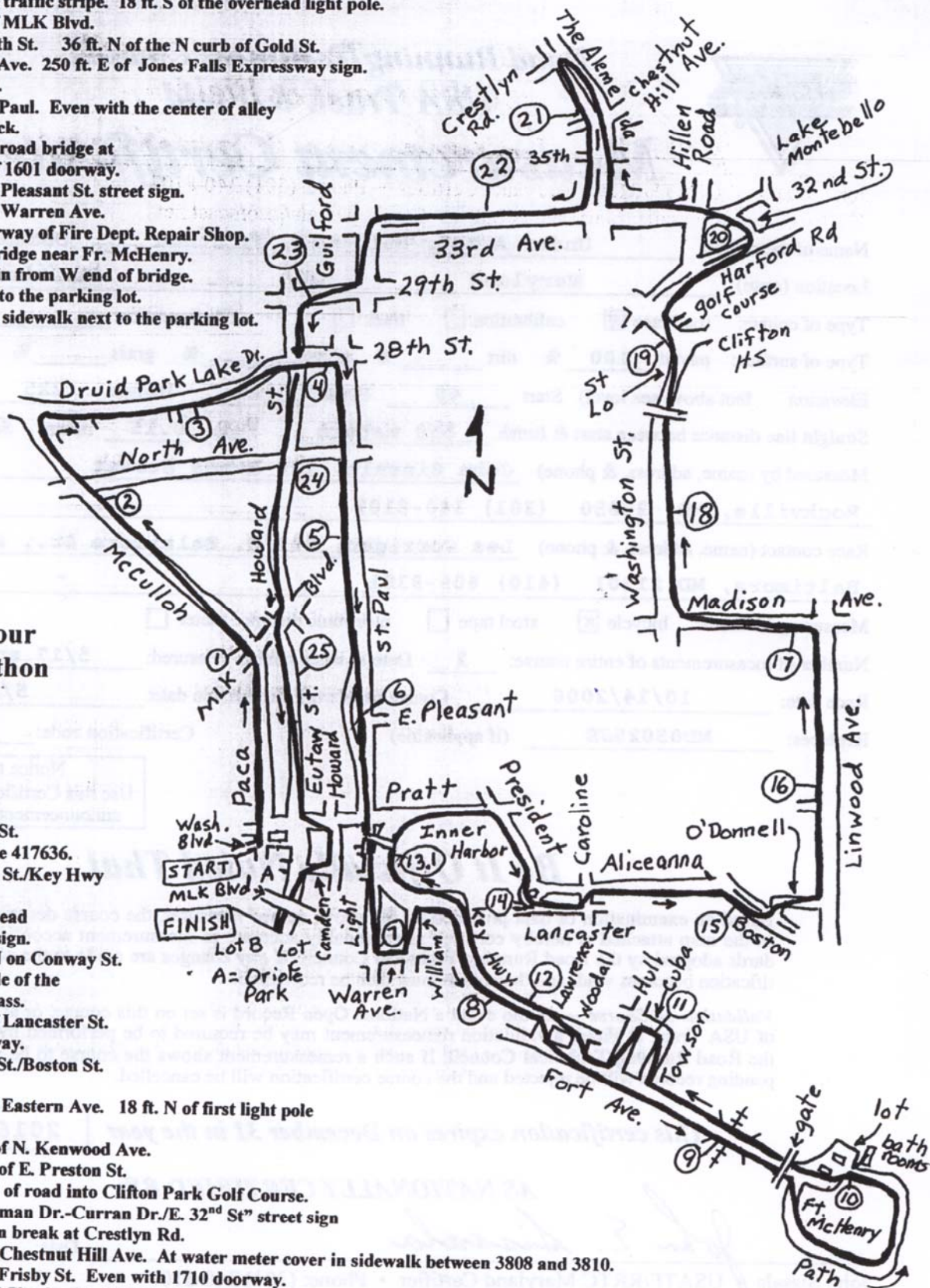

The Under Armour Baltimore Marathon Baltimore, Maryland

USATF

Certification

Number: MD06009JS

M 11: 25 ft. W of Towson St. Even with G&E pole 417636.

M 12: 28 ft. W of Webster St./Key Hwy street sign.

M 13: 21 ft. N of the overhead "Lee Street" street sign.

H. Mar: Approx. 130 ft. N on Conway St. 3 ft. S of the S side of the pedestrian overpass.

M 14: Approx. 100 ft. N of Lancaster St. 43 ft. S of 717 doorway.

M 15: 40 ft. W of Wagner St./Boston St. street sign.

M 16: Approx. 150 ft. N of Eastern Ave. 18 ft. N of first light pole on W side of street.

M 17: 10 ft. from W curb of N. Kenwood Ave.

M 18: 54 ft. S of the S curb of E. Preston St.

M 19: 34 ft. S of the S curb of road into Clifton Park Golf Course.

M 20: 14 ft. E of the "Whitman Dr.-Curran Dr./E. 32nd St" street sign Turn: At S curb of median break at Crestlyn Rd.

M 21: Approx. 250 ft. N of Chestnut Hill Ave. At water meter cover in sidewalk between 3808 and 3810.

M 22: Approx. 100 ft. E of Frisby St. Even with 1710 doorway.

M 23: Approx. 150 ft. W of Charles St. 30 ft. E of doorway to 5.

M 24: Approx. 350 ft. S of North Ave. 15 ft. S of the first light pole on the bridge.

M 25: Approx. 100 ft. S of Druid Hill Ave./W. Centre St. 12 ft. N of 616 doorway.

M 26: On Eutaw St "spine" S of S gate into Oriole Park. 44 ft. S of planter. Center of second brick diamond.

FINISH: On spine between lots B and C just S of the MLK overpass. Even with the second light pole S of the overpass.

Measured on 5/17/2006 and 5/24/2006 to USATF certification standards by J. Sissala.